

29 MAYIS ÜNİVERSİTESİ

ASANSÖR KUYUSU

ASANSÖR KUYULARINDA HAZIR OLAN ÇELİK İŞLERİ :

- 1- Kuyu ara bölme çeliği + kuyu boyu dikme
- 2- Asansör kat kapısı lentosu
- 3- Asansör kuyu dibi merdiveni
- 4- Kuyu üstü taşıma kancası
- 5- Kapı yanlı dikme
- 6- Ara bölme seperatörü

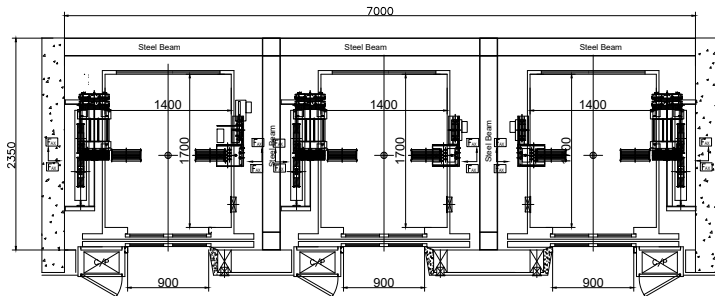

REACTION OF HOISTWAY			
FAX	FAY	F _{BX}	F _{BY}
2.8	4.9	3.0	5.1

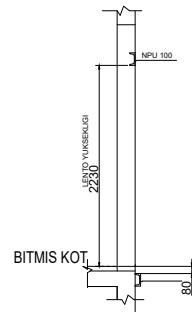
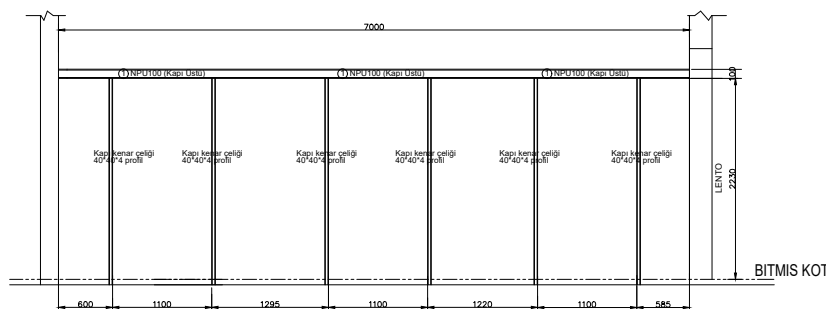
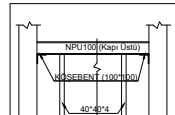
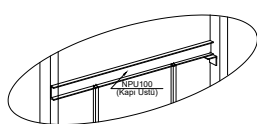
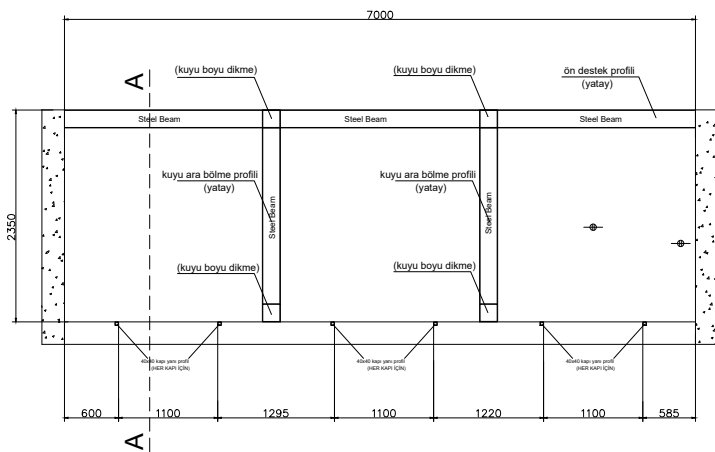

HER BİR ASANSÖR İÇİN 1 ER ADET OLACAK
(MONTAJI ASANSÖR MONTAJI YAPILDIKTAN SONRA YAPILACAKTIR.)

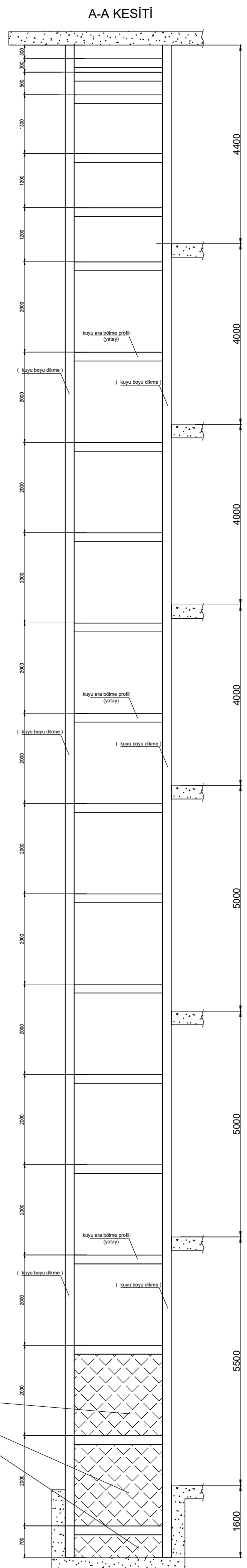
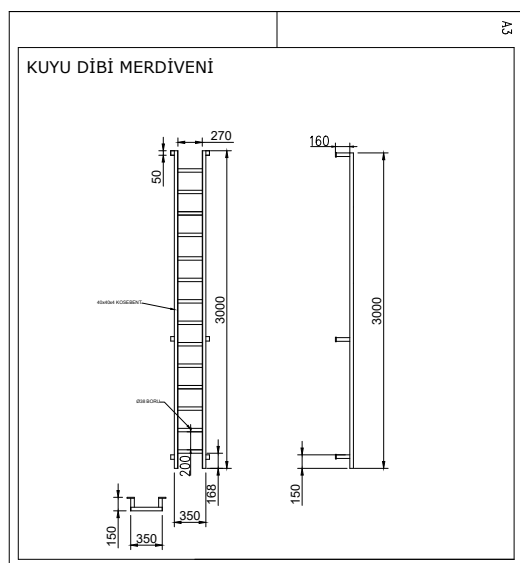

ARA BÖLME SEPARATORÜ